

**ITEM 6. ITEM FOR COMMITTEE INFORMATION – PARKING – DRUITT
STREET BETWEEN GEORGE AND SUSSEX STREETS SYDNEY**

TRIM RECORD NO: 2016/122996

RECOMMENDATION

It is recommended that the Committee not the following reallocation of parking:

- (A) Northern side of Druitt Street, between Sussex Street and the point 17.9 metres, east of Sussex Street as “No Stopping”;
- (B) Southern side of Druitt Street, between the points 10.2 metres and 50.2 metres west of Kent Street as “Bus Zone”;
- (C) Southern side of Druitt Street between Kent and George Streets as “No Stopping”; and
- (D) The City, in conjunction with TfNSW, to review the provision of parking in Druitt Street, between George and Sussex Streets, six months after implementation.

DECISION

BACKGROUND

On 19 December 2013, the NSW Government adopted the Sydney City Centre Access Strategy (Access Strategy). The Access Strategy will deliver a fully integrated transport network in Sydney’s City Centre that puts the customer first and meets the growing transport task. It will mean more people use public transport to access the City Centre and it will change the way people move around within it.

The Access Strategy considers all transport modes and demonstrates how light rail, buses, trains, ferries, cars, taxis, pedestrians and cyclists will interact in the heart of Sydney. The Access Strategy also provides a clear direction for how all the different transport modes will work together in the Sydney CBD to reduce congestion, provide for future growth and improve the customer experience.

The Sydney City Centre Bus Plan (SCCBP) forms part of a suite of transport improvements associated with the Access Strategy and includes:

- New dedicated Bus Lanes, Bus Stops and shelters;
- Modifying kerbs and footpaths, line markings and medians; and
- Removing and relocating some taxi ranks, Loading Zones and on-street parking spaces.

The SCCBP aims to:

- Provide a more efficient bus network that is easier for customers to use and understand;
- Create bus corridors within the CBD that improve links to key destinations and improve connectivity with other transport modes; and
- Relocate existing bus routes on George Street to enable delivery of the CBD Light Rail.

The SCCBP will be delivered by Roads and Maritime Services (RMS), in conjunction with Transport for New South Wales (TfNSW) and the City of Sydney.

COMMENTS

The kerb spaces on both sides of Druitt Street between George and Sussex Streets is generally signposted as “Bus Zone” and “No Stopping”.

Druitt Street between George and Sussex Streets is identified in the Access Strategy as being part of a key bus corridor. The bus corridor includes the “No Stopping” and “Bus Zone” restrictions.

Where possible, loading, taxi and parking for people with disabilities will be distributed to neighbouring streets, contained within the proposed changes for the bus and cycleway plans.

CONSULTATION

The RMS publically exhibited the Review of Environmental Factors (REF) from 23 June to 25 July 2014. Notification of the REF included a letterbox drop to 36,000 properties, a dedicated website, a drop-in centre and visits and meetings with 200 stakeholders within the affected area.

Of the 36,000 letters distributed, the RMS received 60 submissions. Of these 17 supported the proposal, 31 opposed the proposal and 12 where neutral.

Submissions opposing the proposal were concerned about the loss of loading and parking spaces, increased noise and impact to business.

Submissions supporting the proposal believed the proposal would improve public transport access to the City and reduce general traffic congestion.

Included in the consultation process, meetings were held with individual stakeholders who raised concerns about the proposals. The proposal was amended based on these concerns to better meet the needs of the community within the allowable scope of the project objectives.

FINANCIAL

The SCCBP is being fully funded by the NSW State Government.

ATTACHMENTS

Item for Committee Information – Parking – Druitt Street between George and Sussex Streets Sydney

Stephen Sherwin, Project Manager – Roads and Maritime Services

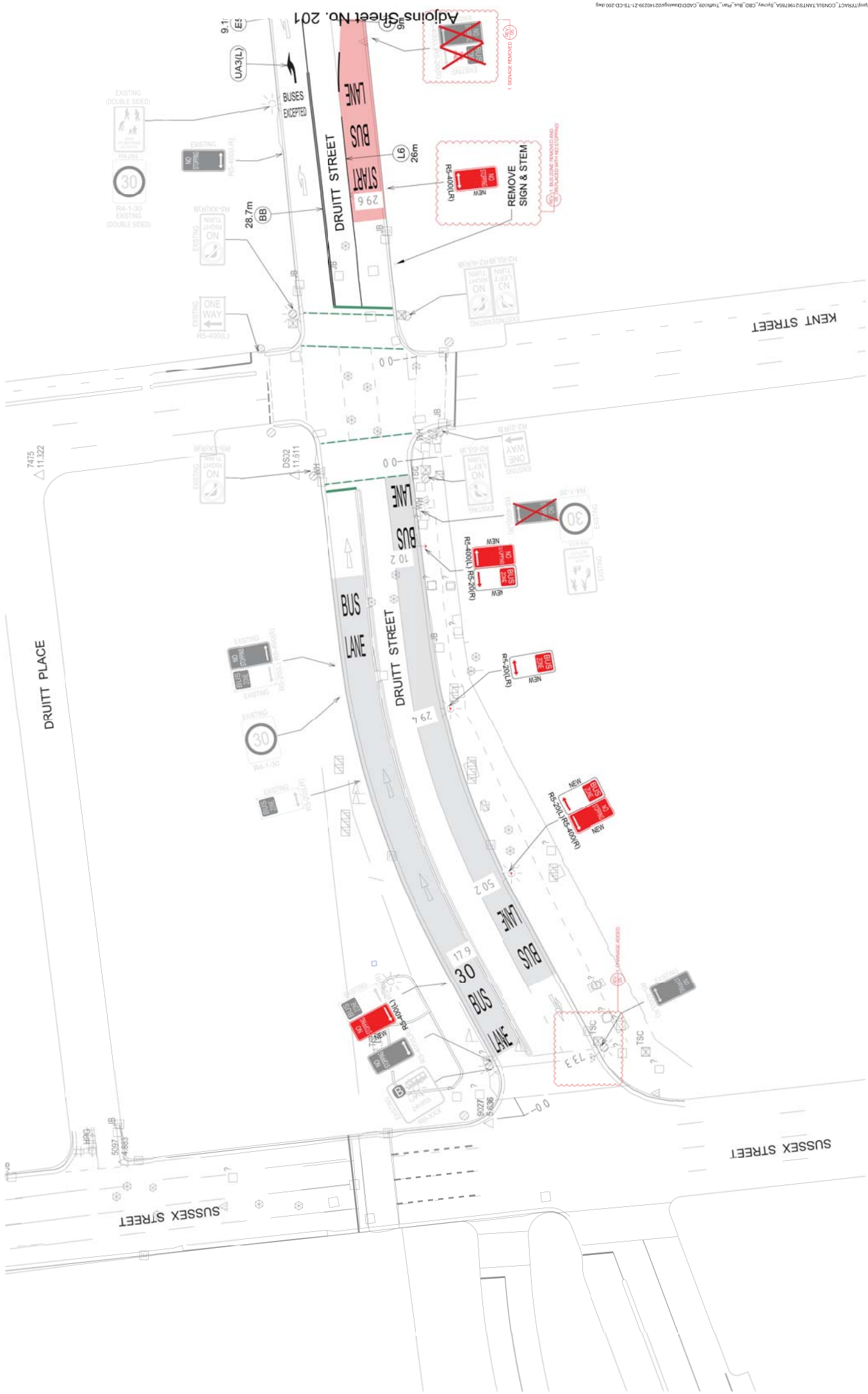

These designs, plans and specifications and the copyright therein are the property of TRACT CONSULTANTS PTY LTD. and may not be used, reproduced or copied, wholly or in part, without the written permission of TRACT CONSULTANTS PTY LTD.



PARSONS BRINCKERHOFF
Level 27, Bond & Young Centre
800 George Street
Sydney, NSW 2000
Telephone: +61 2 9272 5100
Facsimile: +61 2 9272 8101
Email: parsonsbrinckerhoff.com.au

No.	Description	Date	By	Check
01	ISSUE FOR CONSTRUCTION	25.10.14	EVW	
02	ISSUE FOR CONSTRUCTION	13.11.14	EVW	
03	ISSUE FOR CONSTRUCTION	14.01.15	EVW	
04	REVISED NAME SHEET	15.05.15	EVW	
05	REVISED NAME SHEET	16.06.15	EVW	

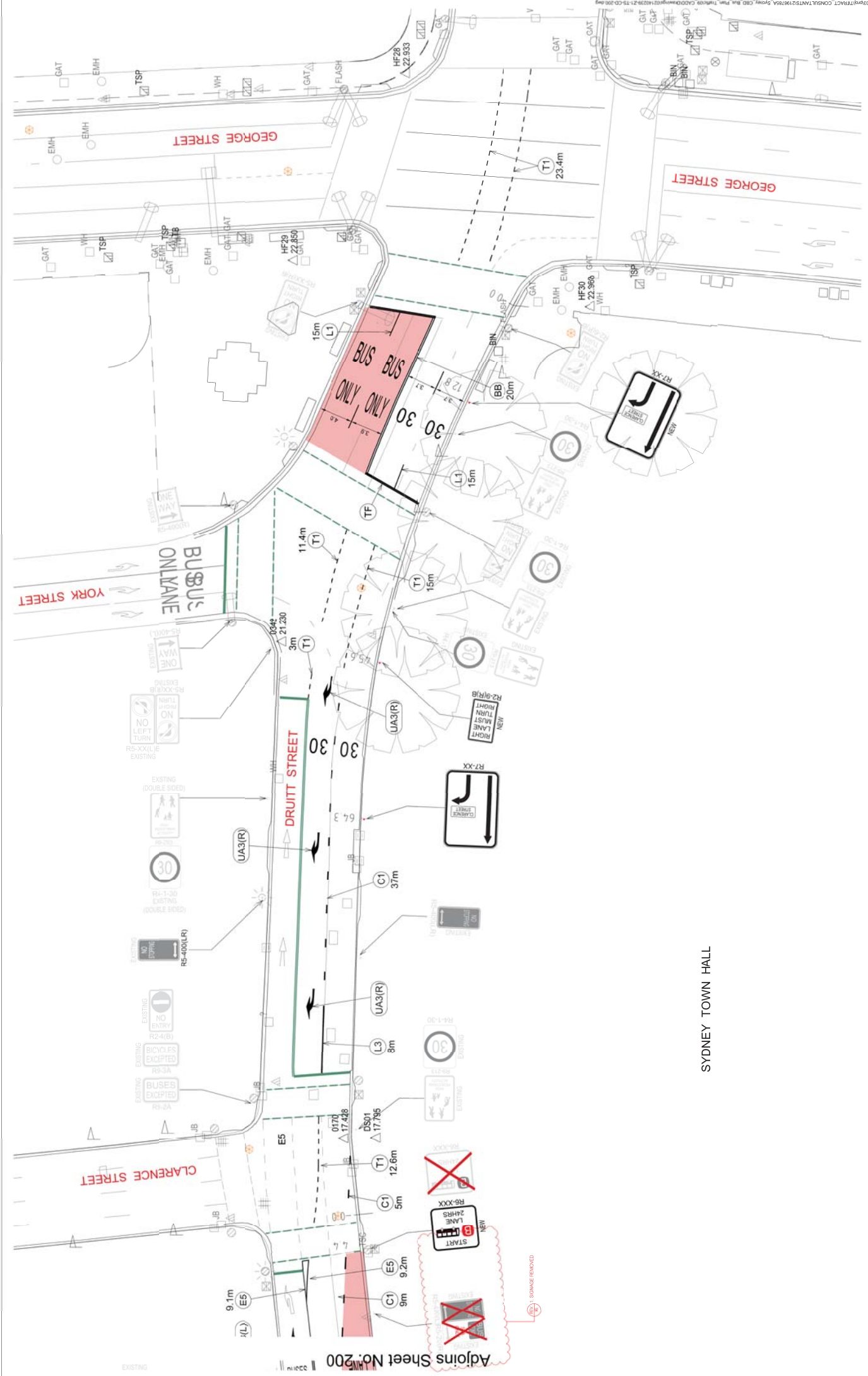

Adjoins Sheet No: 200

SYDNEY TOWN HALL

NO.	REVISION	DATE	BY	CHECKED
1	ISSUE FOR CONSTRUCTION	28/11/14	J.L.	J.L.
2	ISSUE FOR CONSTRUCTION	28/11/14	J.L.	J.L.
3	ISSUE FOR CONSTRUCTION	28/11/14	J.L.	J.L.
4	ISSUE FOR CONSTRUCTION	28/11/14	J.L.	J.L.
5	ISSUE FOR CONSTRUCTION	28/11/14	J.L.	J.L.
6	ISSUE FOR CONSTRUCTION	28/11/14	J.L.	J.L.
7	ISSUE FOR CONSTRUCTION	28/11/14	J.L.	J.L.
8	ISSUE FOR CONSTRUCTION	28/11/14	J.L.	J.L.
9	ISSUE FOR CONSTRUCTION	28/11/14	J.L.	J.L.
10	ISSUE FOR CONSTRUCTION	28/11/14	J.L.	J.L.

Level: ZJ, E-mail & Young Coates
 800 George Street
 Sydney NSW 2000
 Telephone: +61 2 9272 5100
 Facsimile: +61 2 9272 5101
 Email: sydney@brinckerhoff.com

PARSONS BRINCKERHOFF
 The new state of business
 NSW NOW

landscape architects
 planners & urban designers
 100 Pitt Street Sydney NSW 2000
 Telephone: +61 2 9252 3300
 Facsimile: +61 2 9252 3301
 Email: sydney@tract.com.au

TRACT
 SYDNEY CITY CENTRE
 BUS INFRASTRUCTURE

TRAFFIC SIGNAGE PLAN
 DRUIITT STREET
 SHEET 2 OF 2
 02/14/2015, 15:15:15
 A1
 08